

# Yealink

## Video Conferencing Soundbar MSpeaker II

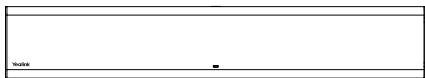

English | 简体中文

**Quick Start Guide(V1.2)**

# Package Contents

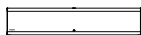

MSpeaker II



(116.16 mm \* 166.41 mm)  
Wall Mount Bracket



Expansion screws  
and Self-tapping screws



(3.5 m, 11.48 ft)  
Power Adapter (48V/0.7A)



(3m, 9.84ft)  
3.5mm Audio Cable



(φ38\*1.2mm)  
Silicone Pad×2



Quick Start Guide



We recommend that you use the accessories provided or approved by Yealink. The use of unapproved third-party accessories may result in poor performance.

## MSpeaker II Connection

### ● Connect the MSpeaker II via 3.5mm audio cable

Connect the MSpeaker II to the Line Out port of the video conference system or the UVC series camera as an audio output device. The following is an example of connecting to the UVC80.

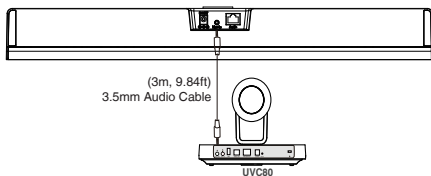

### ● Connect the MSpeaker II via Ethernet cable

Connect the MSpeaker II to the VCH/Phone port of the VC880/VC800/VC500 video conference system as an audio output device. The following is an example of connecting to the VC800.

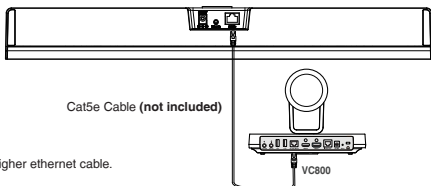

CAT5e or higher ethernet cable.

# MSpeaker II Installation

## ● Mount on a Wall

### Horizontal installation

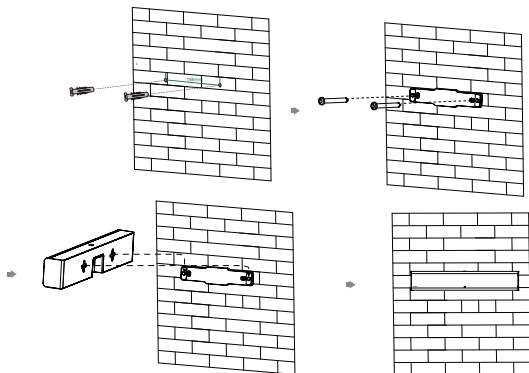

### Vertical installation

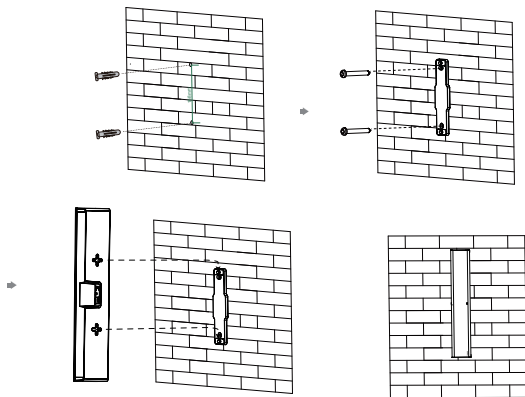

## ● Stick to the Table

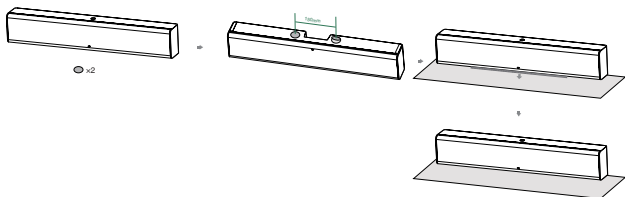

## LED Indicator Instructions

LED Status	Description
Off	The device is powered off.
Solid green	The device is active.
Fast-flashing green	The device is pairing Bluetooth.
Slowly-flashing green	The device connects to Bluetooth successfully.
Red and green flashing alternately for 2s	The device is in initialling.

# 包装清单



MSpeaker II



(116.16 mm \* 166.41 mm)

挂墙架

× 2  $\phi 6 \times 30$  mm, white, Polyamide  
× 2 4\*30 FAHOZNS+ (+)

膨胀螺丝和自攻螺丝



(3.5 m, 11.48 ft)

电源适配器(48V/0.7A)



(3m, 9.84ft)

3.5mm音频线



( $\phi 38 \times T 1.2$ mm)

硅胶垫×2



快速入门指南



我们推荐使用由Yealink提供或经Yealink认可的配件和线缆，使用未经认可的第三方配件和线缆可能会导致性能的下降。



此为A级产品。在生活环境中，该产品可能会造成无线电干扰。在这种情况下，可能需要用户对干扰采取切实可行的措施。

## 连接MSpeaker II

### ● 3.5mm音频线连接

MSpeaker II 可作为音频输出设备连接到会议电视终端或UVC系列摄像机的Line Out接口。以下是MSpeaker II 接到UVC80的图例：

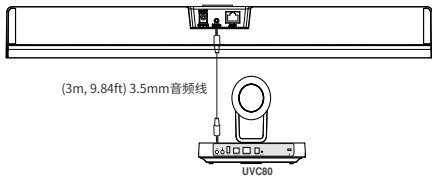

### ● 网线连接

MSpeaker II 可作为音频输出设备连接到VC880/VC800/VC500会议电视终端的VCH/Phone接口。

以下是MSpeaker II 接到VC800的图例：

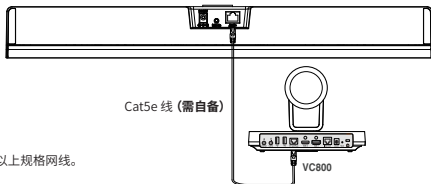

CAT5e及以上规格网线。

# 安装MSpeaker II

选择以下任何一种安装方式:

- 墙装

横挂

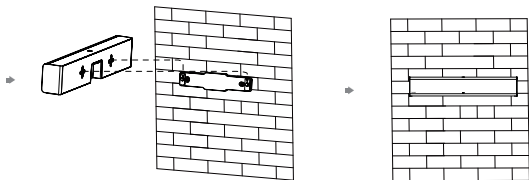
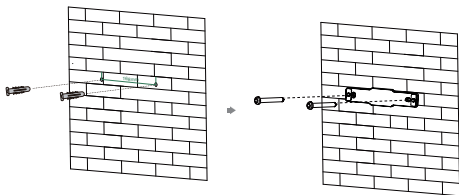

竖挂

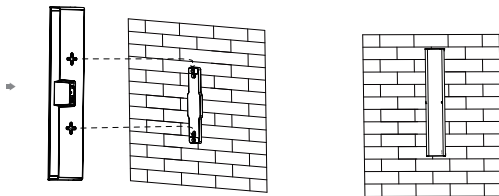
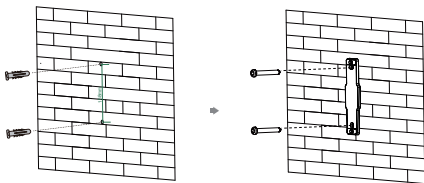

- 固定在桌面上

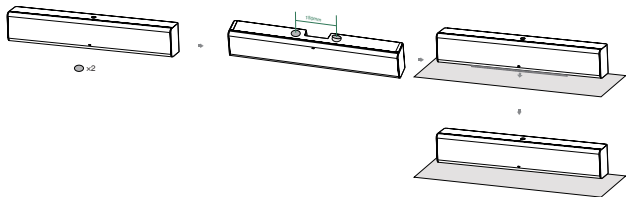

## 指示灯介绍

指示灯状态	说明
关闭	设备关闭。
绿灯常亮	设备处于正常工作状态。
绿灯快闪	设备正在配对蓝牙。
绿灯慢闪	设备成功配对蓝牙。
红绿灯交替闪烁2秒	设备正在初始化。

## Regulatory Notices

### Operating Ambient Temperatures

- Operating temperature: -32 to 104°F (0 to 40°C)
- Relative humidity: 5% to 90%, noncondensing
- Storage temperature: -22 to +160°F (-30 to +70°C)

### Warranty

Our product warranty is limited only to the unit itself, when used normally in accordance with the operating instructions and the system environment. We are not liable for damage or loss resulting from the use of this product, or for any claim from a third party. We are not liable for problems with Yealink device arising from the use of this product; we are not liable for financial damages, lost profits, claims from third parties, etc., arising from the use of this product.

### Explanation of the symbols

#### ● DC symbol

— is the DC voltage symbol.

#### ● WEEE Warning symbol

To avoid the potential effects on the environment and human health as a result of the presence of hazardous substances in electrical and electronic equipment, end users of electrical and electronic equipment should understand the meaning of the crossed-out wheeled bin symbol. Do not dispose of WEEE as unsorted municipal waste and have to collect such WEEE separately.

### Restriction of Hazardous Substances Directive (RoHS)

All adapter devices comply with the requirements of the EU RoHS Directive. Statements of compliance can be obtained by contacting support@yealink.com.

### Safety Instructions

Save these instructions. Read these safety instructions before use!

#### ⚠ General Requirements

- Before you install and use the device, read the safety instructions carefully and observe the situation during operation.
- During the process of storage, transportation, and operation, please always keep the device dry and clean, avoid collision and crash.
- Please attempt not to dismantle the device by yourself. In case of any discrepancy, please contact the appointed maintenance center for repair.
- Please refer to the relevant laws and statutes while using the device. Legal rights of others should be respected as well.

#### ⚠ Environmental Requirements

- Place the device at a well-ventilated place. Do not expose the device under direct sunlight.
- Keep the device dry and free of dusts.
- Do not place the device on or near any inflammable or fire-vulnerable object, such as rubber-made materials.
- Keep the device away from any heat source or bare fire, such as a candle or an electric heater.

#### ⚠ Operating Requirements

- Do not let a child operate the device without guidance.
- Do not let a child play with the device or any accessory in case of accidental swallowing.
- Please use the accessories provided or authorized by the manufacturer only.
- The power supply of the device shall meet the requirements of the input voltage of the device. Please use the provided surge protection power socket only.
- Before plugging or unplugging any cable, make sure that your hands are completely dry.
- Do not spill liquid of any kind on the product or use the equipment near water, for example, near a bathtub, washbowl, kitchen sink, wet basement or near a swimming pool.
- During a thunderstorm, stop using the device and disconnect it from the power supply. Unplug the power plug and the Asymmetric Digital Subscriber Line (ADSL) twisted pair (the radio frequency cable) to avoid lightning strike.

### About Yealink

Yealink (Stock Code: 300628) is a global brand that specializes in video conferencing, voice communications and collaboration solutions with best-in-class quality, innovative technology and user-friendly experience. As one of the best providers in more than 140 countries and regions, Yealink ranks No.1 in the global market share of SIP phone shipments (Global IP Desktop Phone Growth Excellence Leadership Award Report, Frost & Sullivan, 2019).

### Technical Support

Visit Yealink WIKI (<http://support.yealink.com/>) for the latest firmware, guides, FAQ, Product documents, and more. For better service, we sincerely recommend you to use Yealink Ticketing system (<https://ticket.yealink.com/>) to submit all your technical issues.

- If the device is left unused for a rather long time, disconnect it from the power supply and unplug the power plug.
- When there is smoke emitted from the device, or some abnormal noise or smell, disconnect the device from the power supply, and unplug the power plug immediately.
- Contact the specified maintenance center for repair.
- Do not insert any object into equipment slots that is not part of the product or auxiliary product.
- Before connecting a cable, connect the grounding cable of the device first. Do not disconnect the grounding cable until you disconnect all other cables.

#### ⚠ Cleaning Requirements

- Before cleaning the device, disconnect it from the power supply.
- Use a piece of soft, dry and anti-static cloth to clean the device.
- Keep the power plug clean and dry.

### Troubleshooting

The unit cannot supply power to device other than Yealink device.

There is a bad connection with the plug.

1. Clean the plug with a dry cloth.
  2. Connect it to another wall outlet.
- The usage environment is out of operating temperature range.
1. Use in the operating temperature range.

The cable between the unit and the Yealink device is connected incorrectly.

1. Connect the cable correctly.
  2. You cannot connect the cable properly.
1. You may have connected a wrong Yealink device.
  2. Use the correct power supply.

Some dust, etc., may be in the port.

1. Clean the port.
- Contact your dealer or authorized service facility for any further questions.

### FCC Statement

This device complies with part 15 of the FCC Rules. Operation is subject to the following

two conditions: (1) this device may not cause harmful interference, and (2) this device must accept any interference received, including interference that may cause undesired operation.

Any Changes or modifications not expressly approved by the party responsible for compliance could void the user's authority to operate the equipment.

### IC Statement

This device complies with Industry Canada's licence-exempt RSSs. Operation is subject to the following two conditions:

- (1) this device may not cause interference; and
- (2) this device must accept any interference, including interference that may cause undesired operation of the device. CAN ICES-3(B)

Le présent appareil est conforme aux CNR d'Industrie Canada applicables aux appareils radio exempts de licence. L'exploitation est autorisée aux deux conditions suivantes :

- (1) l'appareil ne doit pas produire de brouillage;
- (2) l'utilisateur de l'appareil doit accepter tout brouillage radioélectrique subi, même si le brouillage est susceptible d'en compromettre le fonctionnement. NMB-3(B)

### Contact Information

YEALINK NETWORK TECHNOLOGY CO.,LTD.  
309, 3rd Floor, No.16, Yun Ding North Road, Huli District, Xiamen City, Fujian, P.R. China  
YEALINK (EUROPE) NETWORK TECHNOLOGY B.V.  
Strawinskylaan 3127, Atrium Building, 8th floor, 1077ZX Amsterdam, The Netherlands  
YEALINK (USA) NETWORK TECHNOLOGY CO., LTD.  
999 Peachtree Street Suite 2300, Fulton, Atlanta, GA, 30309, USA  
Made in China



YEALINK(XIAMEN) NETWORK TECHNOLOGY CO.,LTD.  
Web: [www.yealink.com](http://www.yealink.com)  
Copyright©2022YEALINK(XIAMEN) NETWORK  
TECHNOLOGY CO.,LTD.All rights reserved.



430104001968