

# Algo 1202 Call Button Installation Sheet

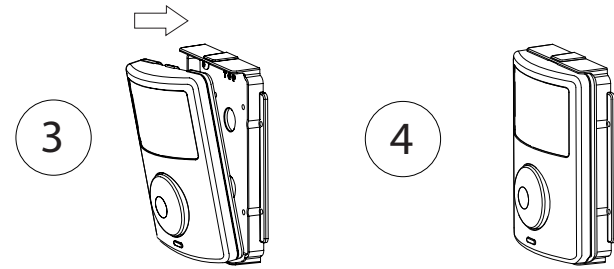

To Install:

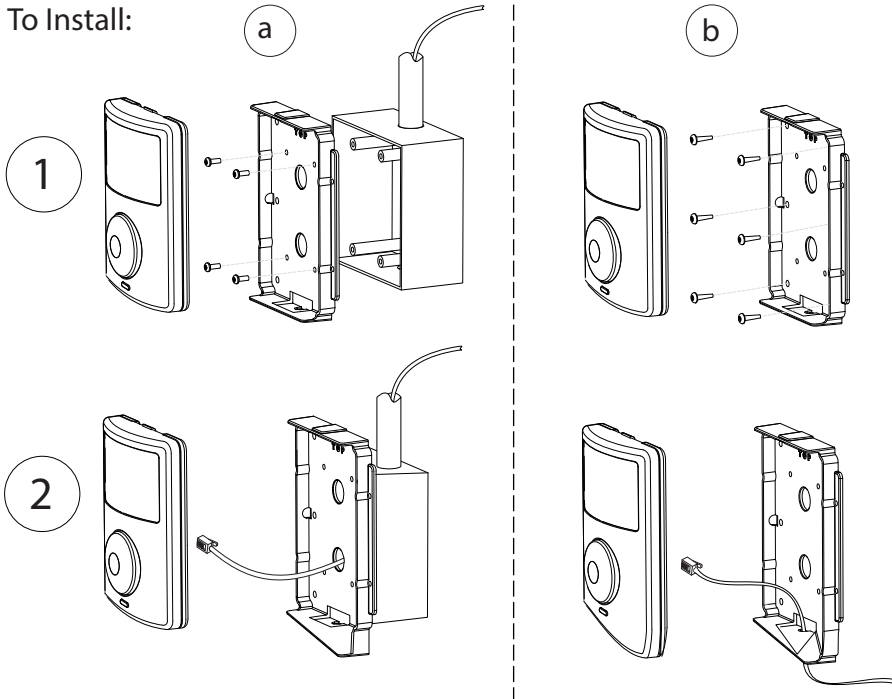

To Remove:

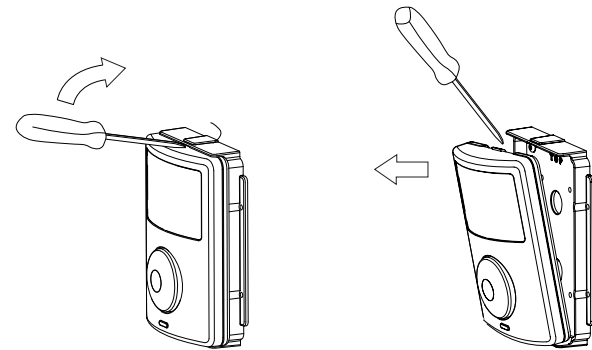

\* The Algo 1202 Call Button is compatible as a relay input device for the Algo 8186, 8188, 8301, and 8061. For configuration information, please refer to the appropriate SIP Endpoint's product user guide on [www.algosolutions.com](http://www.algosolutions.com).

**ALGO**

90-00056